

# COLUMBIA PRODUCTS

## SANI-LAV<sup>®</sup>

### Operating Manual for Two-Person Floor Mounted Wash Stations Model 54FFL



Columbia does not recommend use with harsh chemicals.  
NSF/ANSI Standard 2 - Food Equipment and NSF/ANSI 372 low-lead.

## Parts List

- (1) Two-person floor mount wash station – Model 54FFL
- (1) Leg assembly set
- (4) Washers and nuts for connection sink to leg assembly set
- (2) Chrome-plated faucet with a 10" swivel spout and 4" wing levers (8" on center) – Model 2004
- (2) Faucet mounting kit - Model SMK
- (1) Strainer assembly with basket – Model 1010

## Tools Required

- Tape Measure
- Adjustable Wrench
- Drill Motor and Drill Bits
- Pipe Wrench
- Level
- Safety Glasses
- Screw Drivers: 1 Phillips & 1 Standard
- Pencil
- Socket Wrench

## Installation Instructions

### Step 1

1. Assemble legs for the 54 and 56 series. For series 58, 510 and 512 the legs are pre-assembled.
2. Place wash station sink on the leg assembly. Secure legs to bowl with hardware provided.
3. Place wash station sink at the desired location.
4. Mark the floor where the mounting holes are at the base of the legs. See illustration A.
5. Drill holes as required for mounting hardware. Hardware not included.

### Step 2

1. Install Faucet to the sink using faucet mounting kit provided. We recommend using pipe thread sealant instead of Teflon tape.
2. Install strainer assembly to the drain hole.
3. Connect hot and cold water supply lines (not included) to the back of faucets.

### Step 3

1. Position wash station sinks to pre-drilled holes and secure sink to the floor.
2. Connect waste line or drain pipe to the strainer assembly. Not included.
3. Connect water supply lines (Hot and Cold) to the water source. Not included.
4. Remove aerator from the spout and flush the water system.
5. Replace aerator to the spout.
6. Check for leaks and tighten connections if necessary.

### Step 4

1. Seal gap between bowl and leg assembly as shown in illustration B.
2. When mounting against wall, it is recommended sealing the top of the backsplash to wall as shown on illustration C.

## Trouble Shooting Guide

Problem	Possible Cause	To Diagnose	Remedy
Water drips from the spout or from under the lever.	1. Seat washer is worn 2. Seat is worn 3. O-rings are worn	Shut cold water source off. See if water still leaks from the spout. If leaks continues repair hot side if not repair cold side.	Recommend installing hot or cold faucet repair kit.



Illustration A



Illustration B



Illustration C

## Replacement Parts

Part No.	Description	Quantity	Universal Part
<b>A</b> 2004-1	Faucet Body Assembly	1	YES
<b>B</b> 1062-C	Faucet Valve Repair Kit - Cold	1	NO
<b>C</b> 1062-H	Faucet Valve Repair Kit - Hot	1	NO
<b>D</b> 2004-2	Female Wall Flange Assembly	2	YES
<b>E</b> 2004-3A	Bonnet Nut - Cold	1	NO
<b>F</b> 2004-4A	Bonnet Nut - Hot	1	NO
<b>G</b> 2010-1	Handle 6" inch - Cold	1	NO
<b>H</b> 2010-2	Handle 6" inch - Hot	1	NO
<b>I</b> 2011-1	Handle 4" inch - Cold	1	NO
<b>J</b> 2011-2	Handle 4" inch - Hot	1	NO
<b>K</b> 2012-1	Handle 2.5" inch - Cold	1	NO
<b>L</b> 2012-2	Handle 2.5" inch - Hot	1	NO
<b>M</b> 2004-5	10-24 Oval Csk Screw x .5"	2	YES
<b>N</b> 2003-1	Swivel spout Assembly	1	YES
<b>O</b> 2001-1	12" swivel spout Assembly	1	YES
<b>P</b> 2002-1	6" swivel spout Assembly	1	YES
<b>Q</b> 1002	55/64 - 27 Female aerator	1	YES

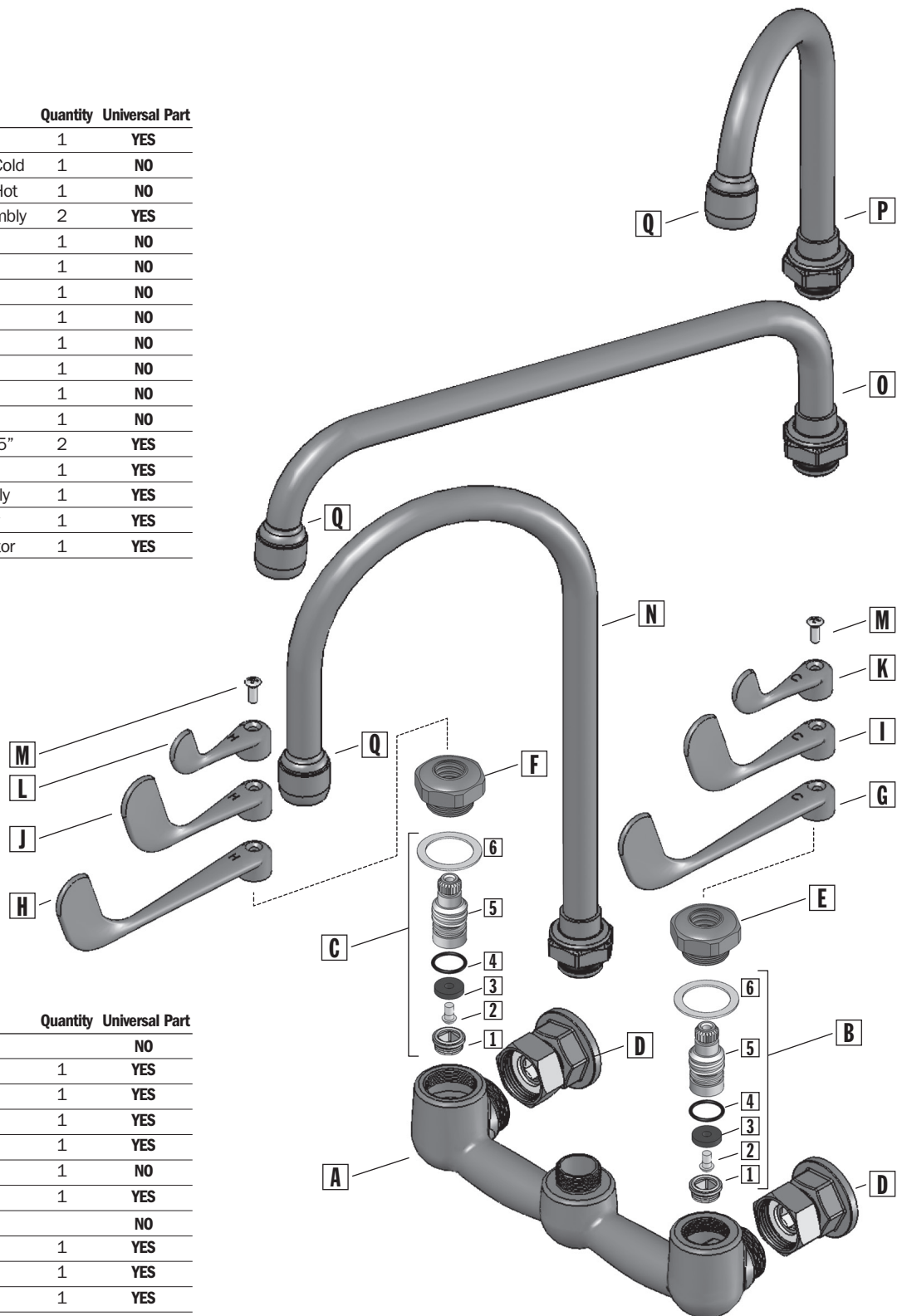

Part No.	Description	Quantity	Universal Part
<b>B</b> 1062-C	Faucet Valve Repair Kit - Cold		NO
1	Seat	1	YES
2	Seat Washer Screw	1	YES
3	Seat Washer	1	YES
4	O-ring	1	YES
5	Valve Stem	1	NO
6	Bonnet Nut Washer	1	YES
<b>C</b> 1062-H	Faucet Valve Repair Kit - Hot		NO
1	Seat	1	YES
2	Seat Washer Screw	1	YES
3	Seat Washer	1	YES
4	O-ring	1	YES
5	Valve Stem	1	NO
6	Bonnet Nut Washer	1	YES

## ■ Top

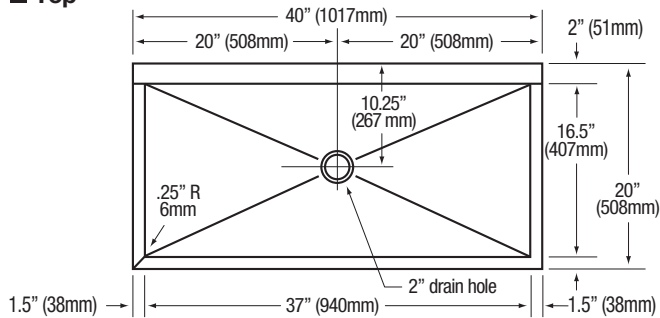

## ■ Front

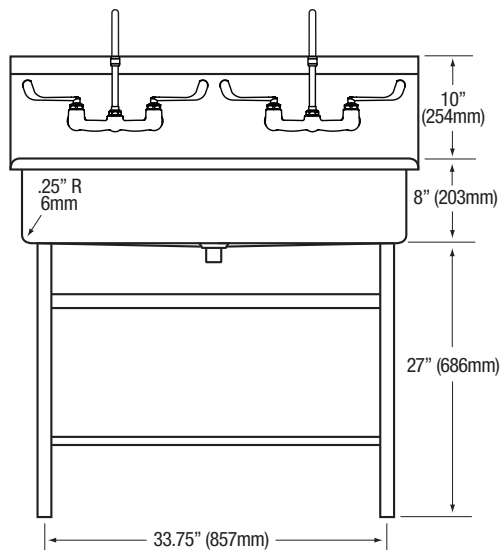

## ■ Hole Configurations

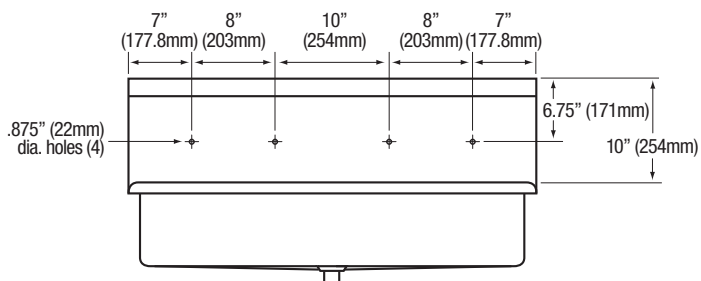

## ■ Side

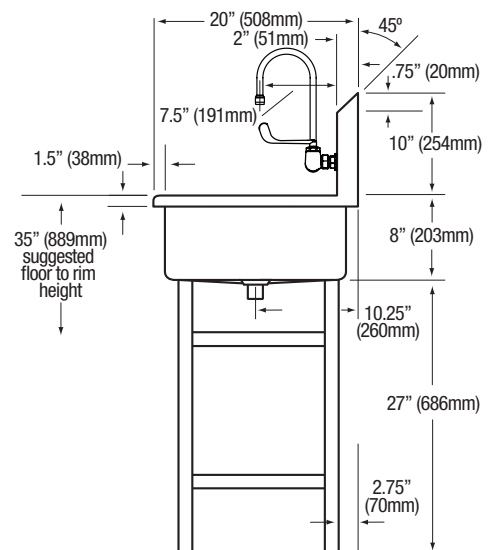

## ■ Leg Specifics

