

## Other

### Safety Signs and Tags



☐ **114-050**  
Drench shower sign



☐ **114-051**  
Eyewash sign

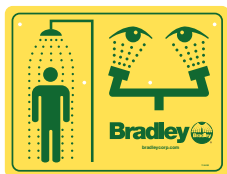

☐ **114-052**  
Combination Drench shower and eyewash sign

### Foot Treadle Kits



☐ **S45-572**  
Foot treadle and hardware kit (with 3-foot chain) for standard pedestal-mounted eyewashes and combination shower/eyewash units with hand operation; provides supplemental foot operation

☐ **S45-1314SS**  
Type 316 stainless steel foot treadle and standard stainless steel hardware kit for stainless steel pedestal-mounted eyewashes and combination shower/eyewash units

☐ **S45-1314SS16**  
Type 316 stainless steel foot treadle and 316 stainless steel hardware kit for Type 316 stainless steel pedestal-mounted eyewashes and combination shower/eyewash units



☐ **S39-395**  
Foot treadle and hardware kit for wall-mounted eyewashes with hand operation; provides supplemental foot operation

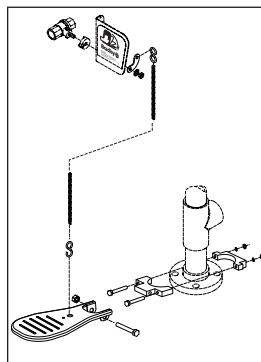

☐ **S45-620**  
Foot treadle and hardware kit for model S19-310PVC combination drench shower and eyewash unit with hand operation; provides supplemental foot operation

### On-Site Portables



☐ **S19-949 On-Site Eyewash Kit**  
Includes replacement cap, nine foam liners, inspection tag

☐ **269-1379 On-Site Water Foam Liner**  
Perforated foam liner (sold individually)



☐ **133-140**  
Gravity fed tank

### Miscellaneous Supplies



☐ **204-421**  
Inspection Tag (sold individually)



☐ **269-964**  
Safety yellow touch-up paint. 12-oz. aerosol

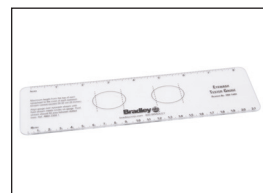

☐ **269-1444**  
Eyewash test gauge