

# AUTO-HITE CART - SCSC-500-4242

APPROX WEIGHT: 331.53 lbs.  
DOES NOT INCLUDE WEIGHT OF POWER OR PACKAGING!!!

\*\*\* ANY ADDITIONS, DELETIONS, OR OMISSIONS MUST BE CORRECTED ON THIS DRAWING AS THIS DRAWING WILL BE CONSIDERED ALL INCLUSIVE \*\*\*

ALL GRAPHICS PROVIDED ARE FOR REFERENCE ONLY. IF CERTAIN DIMENSIONS ARE CRITICAL PLEASE VERIFY THOSE DIMENSIONS WITH YOUR SALESPERSON

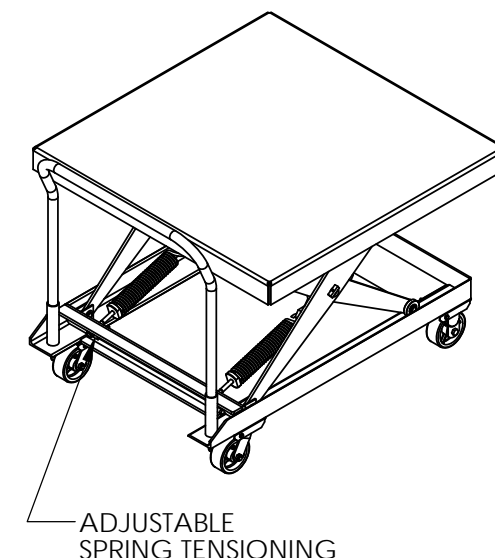
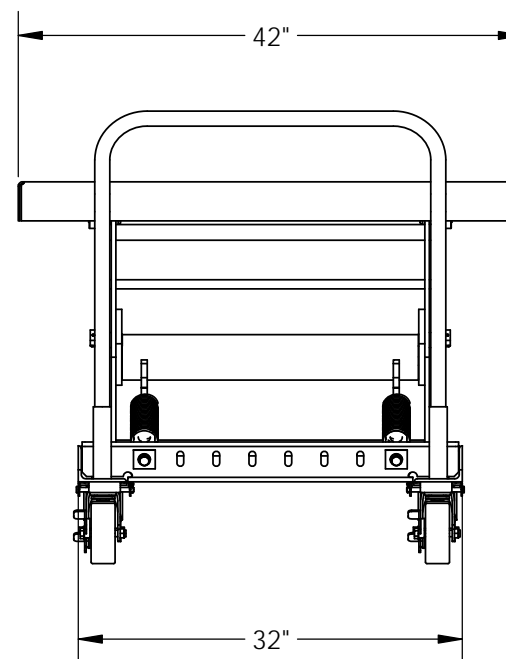
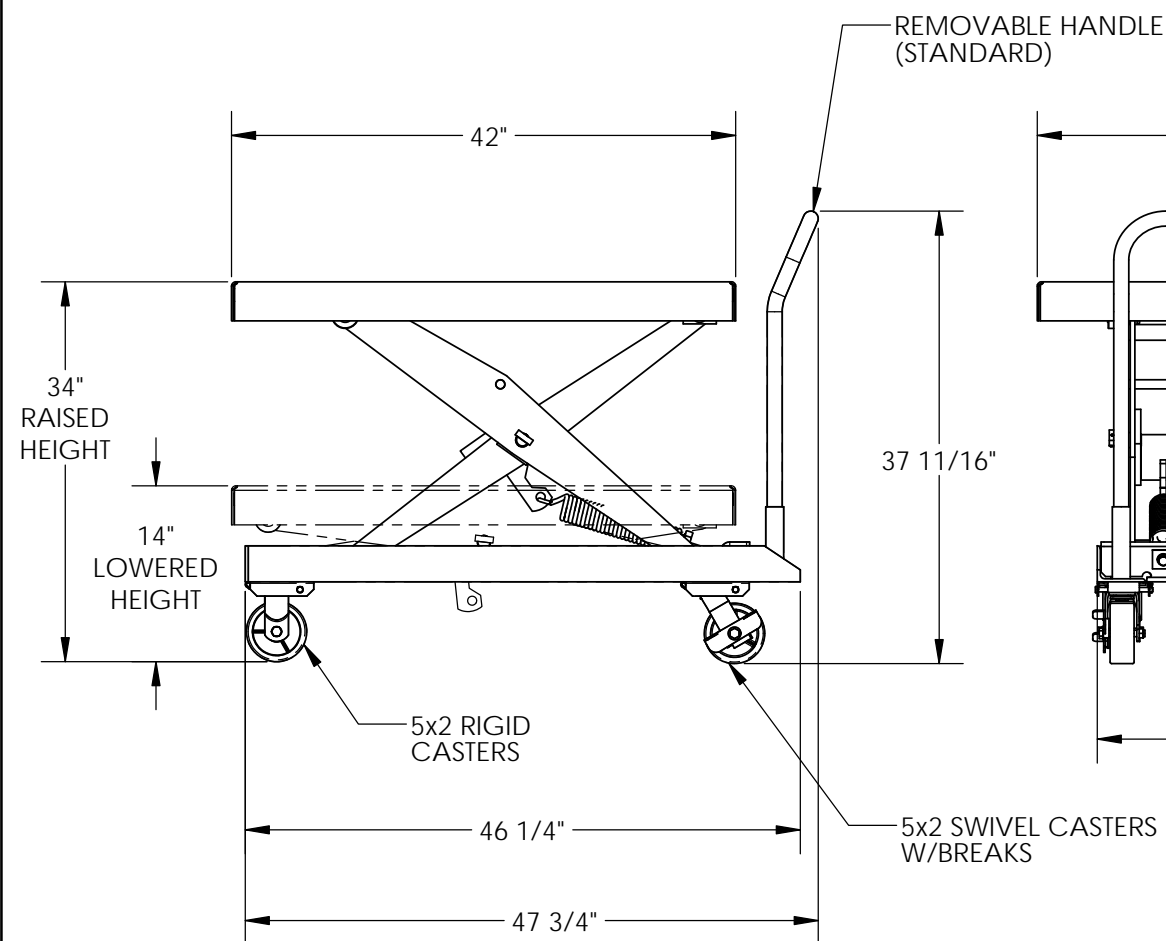

## STANDARD FEATURES

MODEL NUMBER IS SCSC-500-4242  
MAX CAPACITY IS 500 LBS  
DECK SIZE: 42"W x 42"LG  
FRAME SIZE: 32"W x 46 1/4"LG  
RAISED HEIGHT: 34"  
LOWERED HEIGHT: 14"  
TRAVEL: 20"  
5x2 CASTERS (2 SWIVEL W/BRAKE,  
2 RIGID)  
SPRING RATE: 25 LBS/IN  
N° OF SPRINGS: 2

## SPECIAL FEATURES

NONE

DIMENSION TOLERANCE  $\pm 1/4"$

**A  
P  
P  
R  
O  
V  
A  
L**

I, THE UNDERSIGNED, AGREE THAT THE PRODUCT AS REPRESENTED SATISFIES DESIGN AND DIMENSION REQUIREMENTS. I ALSO ACKNOWLEDGE MY DUTY TO CONFIRM PRODUCT AND INSTALLATION COMPLIANCE WITH ALL APPLICABLE FEDERAL, STATE AND LOCAL REGULATIONS AND STANDARDS.  
**ALL SPECIAL UNITS ARE NON-RETURNABLE**  
[ ] As drawn [ ] As marked

Signed: \_\_\_\_\_ Date: \_\_\_\_\_

LEAD TIME WILL START UPON RECEIPT  
OF SIGNED APPROVAL DRAWING

DISTRIBUTOR'S NAME:		P.O.#
VESTIL MANUFACTURING		X
DRAWN BY:	DATE:	W.O.#
X	XX/XX/XX	X
REFERENCE:	SCALE: 1:16	SALES:
X		X
QUOTED LEAD TIME:	QUOTE #	FILE NAME:
X	X	01-007-013